

## PMP-400 Pump, ID 10mm (3/8in)



### Features

The PMP-400 is a high-pressure pump with a very low profile format.

- Maximum Flow Rate: 8.7 L/min (2.3 gal/min)
- Maximum Head Pressure: 7m (23ft)
- Motor: Brushless DC, electronically commutated, spherical motor
- Expected Lifetime: 50,000 hrs. MTBF (5.7 years)
- Power Consumption (at max): 20W
- Voltage Range: 8 to 13.2 VDC
- Startup Voltage: 9 to 13.2 VDC
- Maximum System Pressure: 1.5 kgf/cm<sup>2</sup> (22 PSI)
- Maximum Temperature: 60°C (140°F)
- Electrical Connector: 3-pin fan header with tachometer speed signal
- Tachometer: Open collector, max 20mA/24V, 2 pulses per revolution
- Hose Connections: 10mm (3/8") ID hose barbs
- Wetted Materials: PPO, Carbon/Alumina Ceramic, EPDM or Viton, 316 SS or Plastic.
- Noise: Less than 40dBA
- Weight: 198g (7oz)

## Description

### General

Weight 0.50 lb (0.23 kg)

Dimensions 2.25 x 2.25 x 1.00 in (5.72 x 5.72 x 2.54 cm)

### Materials

Wetted Materials PPO, Carbon/Allumina Ceramic, EPDM or Viton, 316 SS or Plastic

### Pumps

Expected Lifetime 50,000 hrs. MTBF

Max Flow Rate 8.7L/min (2.3GPM)

Max Power 20W

Max Static Head 7.0m (23ft)

Max Temperature 60°C (140°F)

Native Hose Connection Barbs for ID 10mm (3/8in)

### Speed Knob

Tachometer yes

Type Magnetic Centrifugal

Voltage 8-13.2 VDC

## Diagrams

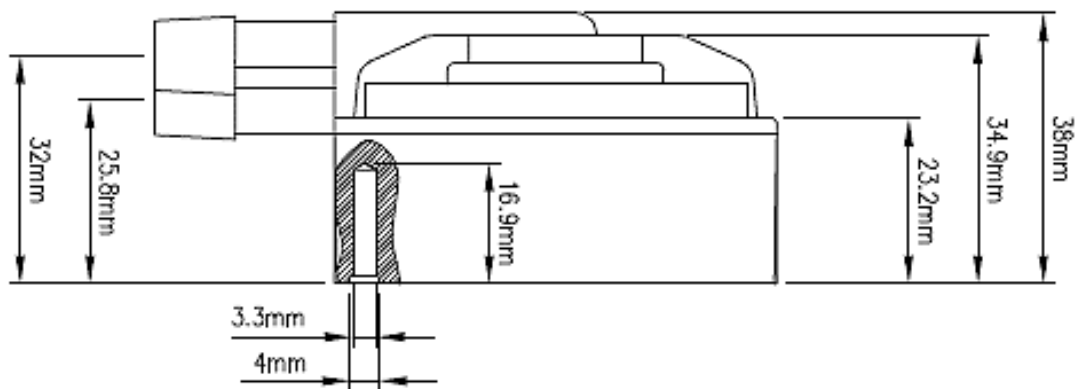

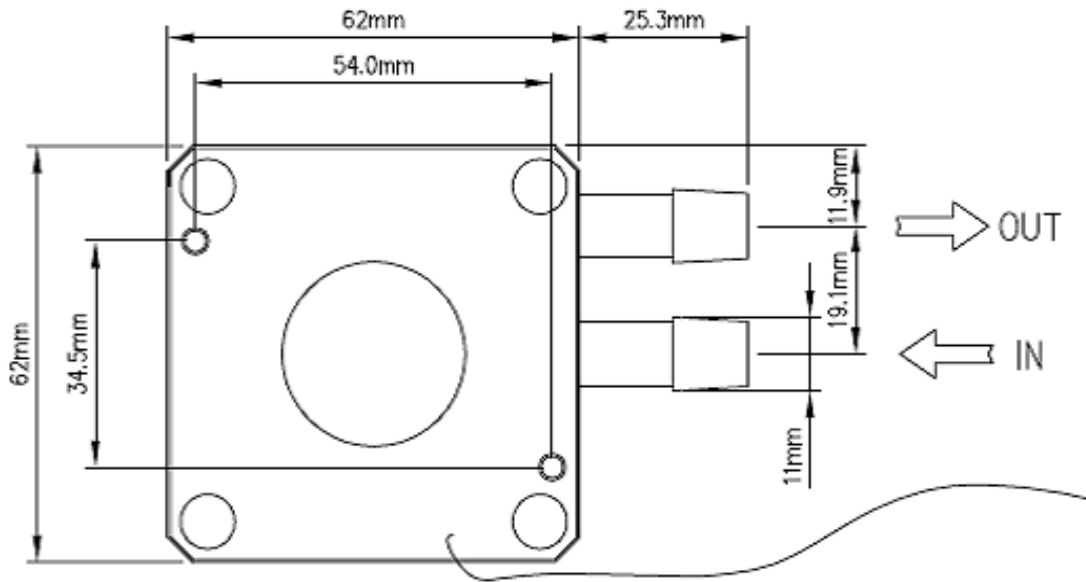

### Performance

Koolance PMP-400 Pump - Flow Curve

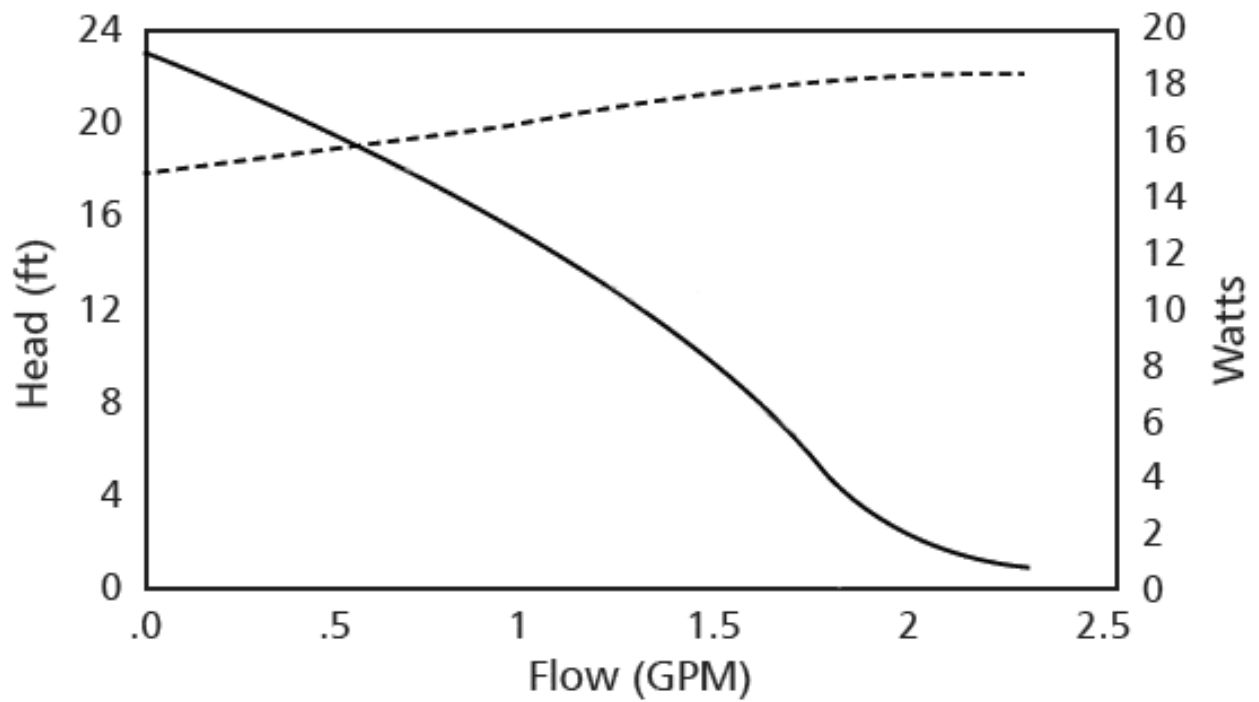

Koolance PMP-400 Pump

