

MCP655™ series 12 VDC Pumps

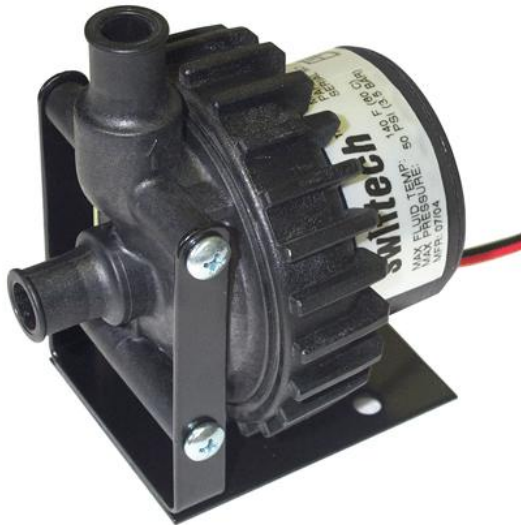

Features

The MCP655™ pump is a high reliability, high pressure industrial pump, featuring a 50,000 hour MTBF (5 year lifetime). Such reliability is afforded by the unique design of this pump, which contains only one moving part: the magnetically driven **spherical impeller** spins on a single ceramic bearing, thus extending the life of this pump beyond existing standards.

The pump is completely plug-and-play, and connects directly to the computer power-supply with a standard 4 pin power connectors. It's compact design, quiet and powerful motor make it ideally suited for heavy duty cooling in environments where space is at a premium.

Summary of benefits

- 50,000 hours MTBF (Mean Time Between Failure) equivalent to 5 years lifetime.
 - Superior 12 Volts DC convenience: plugs into the computer power supply
 - The MCP655™ can be used with full confidence in any MP servers, and high-end workstations.
 - Superior real world performance
 - High pressure capability of the MCP655™ is particularly well adapted to high-flow systems using 1/2" ID tubing
 - Pump speed can be adjusted to yield top performance or virtually silent operations (model MCP655 only)
 - Compact Design.
 - Quiet operations even at high speed thanks to new chipset controller
 - 1/2" Barb fittings.
 - No maintenance when used with de-mineralized water, and anti-fungal additives (Our HydrX™ additive is recommended)
 - Quick installation with adhesive neoprene pad, or permanent installation with thru-bolts.
-

Retention Mechanism

The MCP655™ can either be installed with the built-in neoprene pad featuring a peel-off adhesive back, or permanently with thru-bolts as shown below.

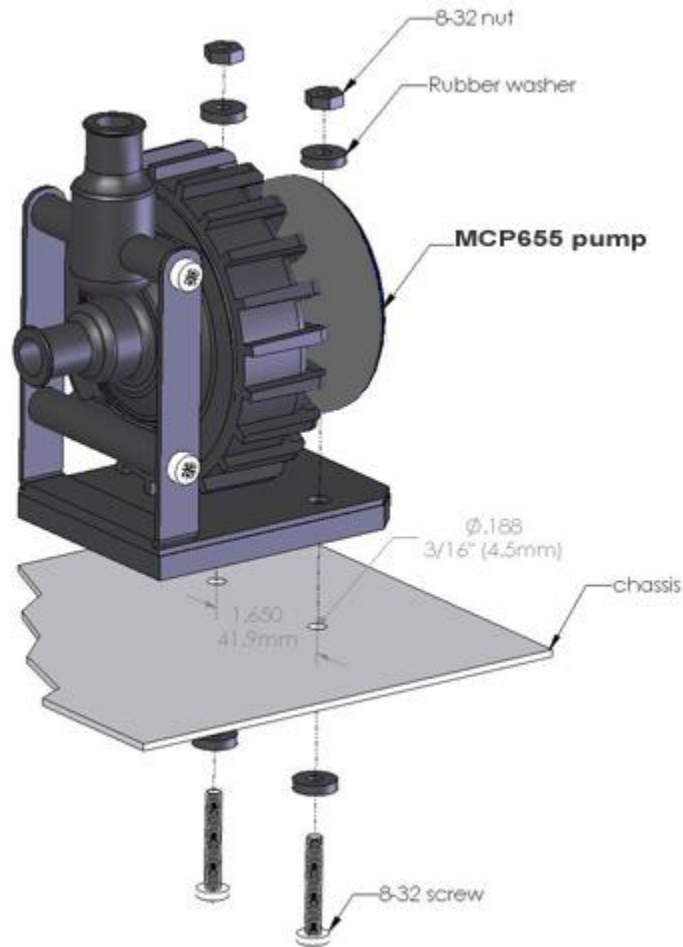

[Back to top](#)

Technical specifications

Nominal voltage	12 V DC
Operating voltage range	8 to 24 VDC
Nominal power (@ 12 V)	24 W
Nominal current (@ 12 V)	2 amps
Motor type	Brushless, microprocessor controlled
Maximum head	10 ft (3.1 m)
Maximum discharge	~ 317 GPH (1200 LPH)
Connection size	½" barbs
Maximum pressure	50 PSI (3.5 BAR)
Temperature range	32 °F to 140°F (0 °C to 60 °C)

Electrical connector
Weight
Impeller Housing material

Molex 4 pin
1.4 LB (650 gr.)
Noryl®

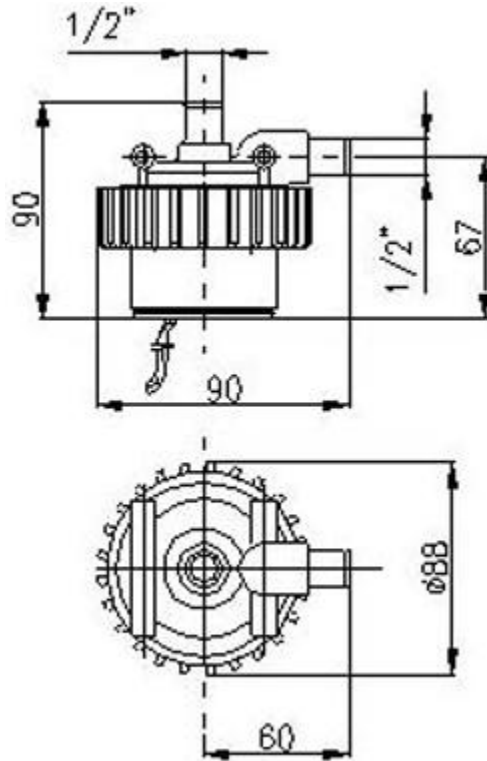

body dimensions in mm

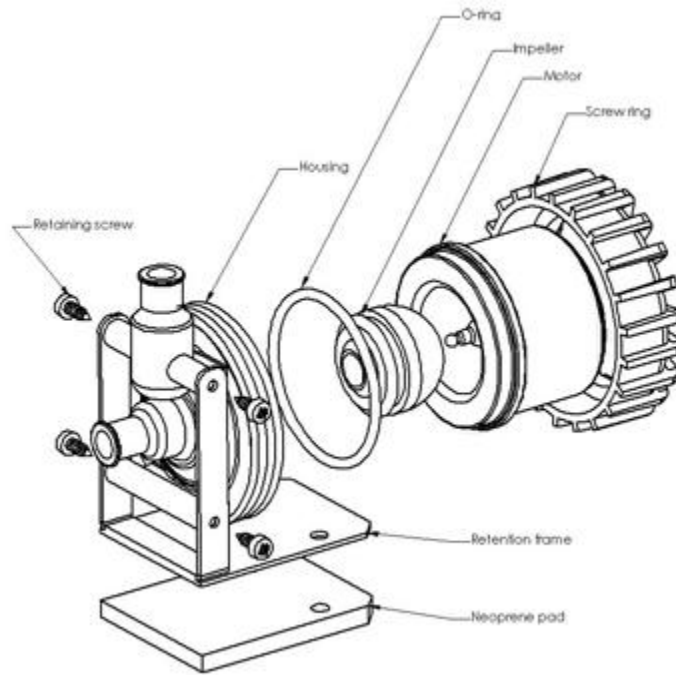
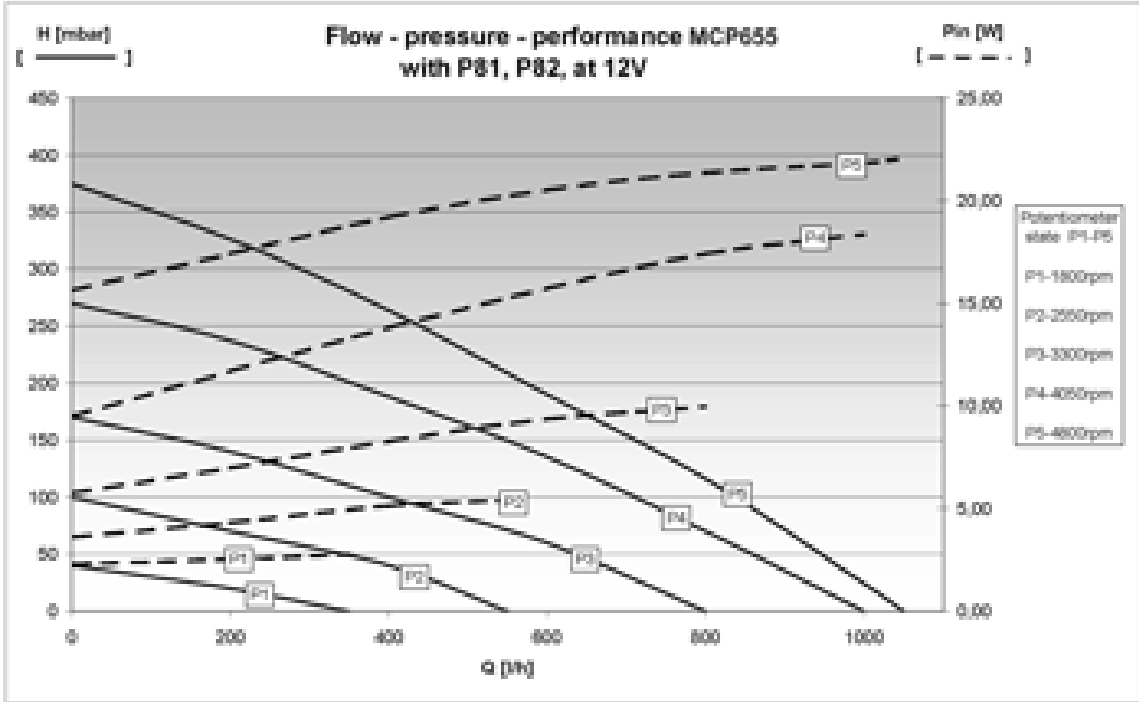

click to enlarge